

**NORTH BEACH WATER DISTRICT  
PACIFIC COUNTY, WASHINGTON**

**RESOLUTION 15-2014**

**A RESOLUTION OF THE NORTH BEACH WATER  
DISTRICT OF PACIFIC COUNTY, WASHINGTON,  
APPROVING THE Z STREET WATER MAIN  
EXTENSION/REPLACEMENT PROJECT.**

**WHEREAS**, the Board of Commissioners of North Beach Water District has determined that the water main on Z Street south of Bay Avenue needs to be connected to the water main on Bay Avenue and increased in size to an eight inch diameter pipe; and

**WHEREAS**, the Board of Commissioners of North Beach Water District approved the first phase of this work with by approving Change Order No. 1 submitted by Big River Excavating, Inc. on January 30, 2014 via Resolution 05-2014; and

**WHEREAS**, the District's General Manager has obtained material and labor quotes for the work 05estimated the project cost will be \$36,583.5; and

**WHEREAS**, the General Manager secured a shared trench proposal with the Public Utility District No. 2 of Pacific County whereby they will reimburse the District \$5,500 toward the cost of the trenching, backfill, and restoration for use of a portion of the trench to install their infrastructure; now, therefore

**BE IT RESOLVED**, by the Board of Commissioners of North Beach Water District, Pacific County, Washington, to approve the Z Street Water Main Extension/Replacement Project as described in the

Cost Estimate:

Units	Description	Unit Cost	Total
1	Materials	\$23,000	\$22,016.41
1	Contract Labor	\$9,500	\$9,500
1	Surveying	\$2,650	\$2,650
1	Contingency 10%	\$3,416.64	\$3,416.64
Total			\$36,583.05

Trench Detail Side View:

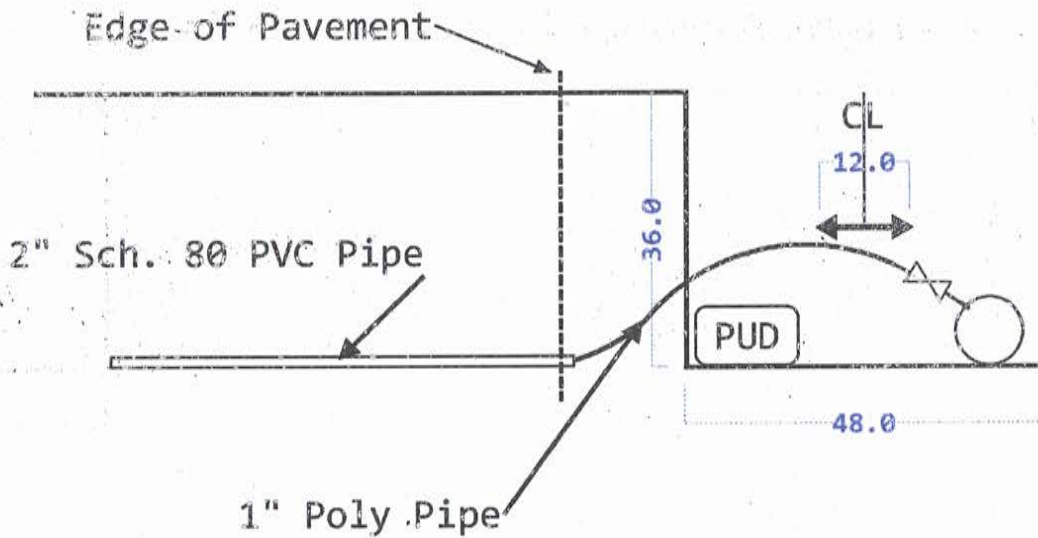

Trench Detail Top View:

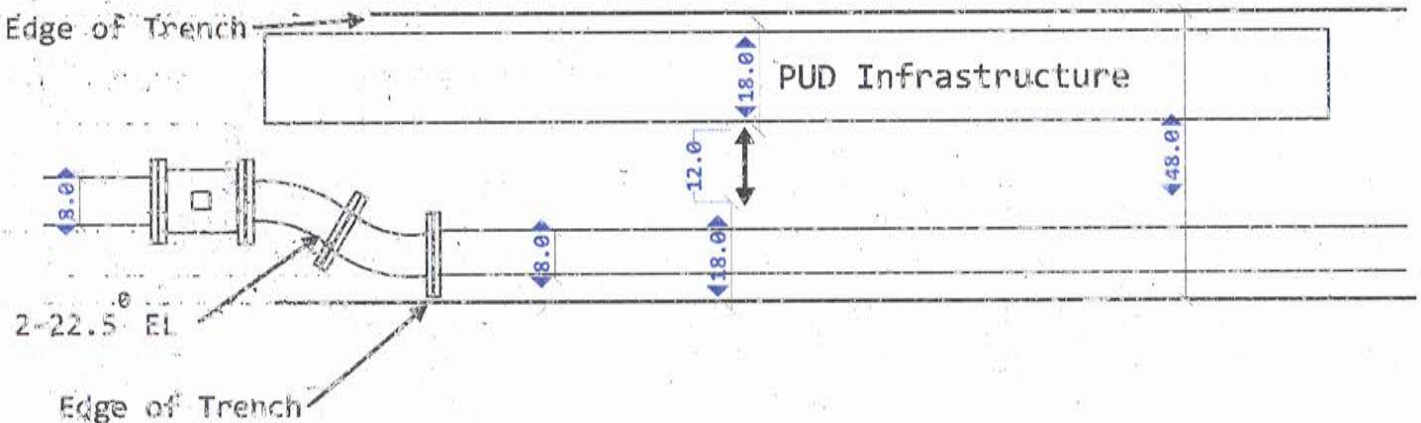

## "Exhibit A"

### Scope of Work

---

**Job Description:** Z Street Water Main Extension/Replacement Project

**Location:** Z Street South of Bay Avenue for 1,400 feet.

**Work Description:**

North Beach Water District will excavate a nominal forty eight inch wide by thirty six inch deep trench on the west side of Z Street starting from a point approximately 20-feet south of Bay Avenue and proceed south within the Pacific County right-of-way for approximately 1,400 feet.

North Beach Water District will install an 8-inch water main in the west side of the trench and Pacific PUD will be installing two- 2-inch conduits in the east side of the trench. North Beach Water District and Pacific PUD will work cooperatively to maintain a minimum 12 inch separation between the water main and the conduit.

North Beach Water District will obtain a permit from Pacific County Department of Public Works for Works in the Right-Of-Way and assume responsibility for all permit conditions, provided; however, Pacific PUD will conform to any permit conditions related to the installation of its conduit.

North Beach Water District will provide all labor and equipment to excavate and backfill the trench and restore the Right-Of-Way.



Cost Estimate:

Units	Description	Unit Cost	Total
1	Materials	\$23,000	\$23,000
1	Contract Labor	\$6,500	\$6,500
1	Surveying	\$	\$
		Total	\$

Trench Detail Side View:

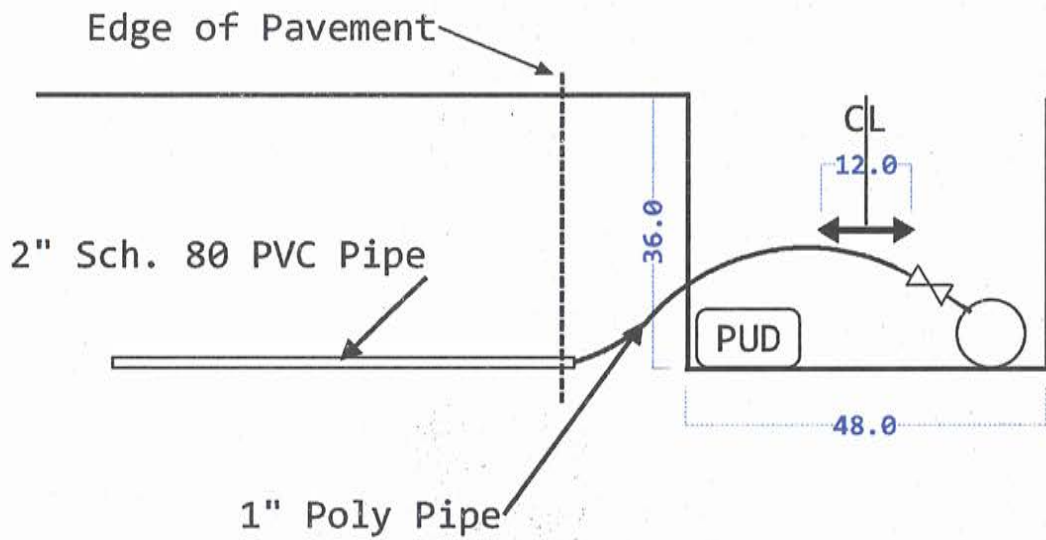

Trench Detail Top View:

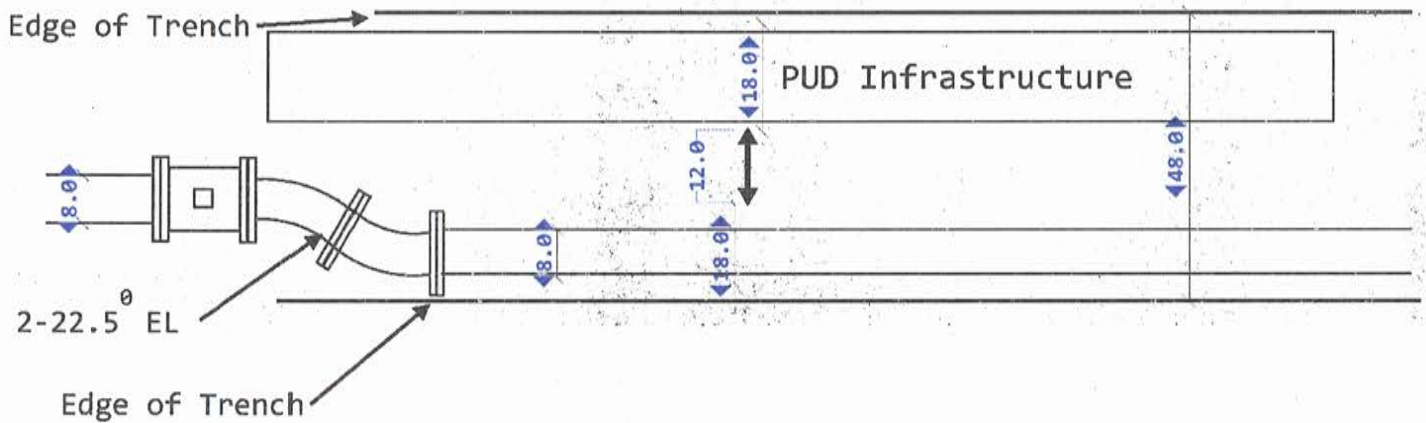

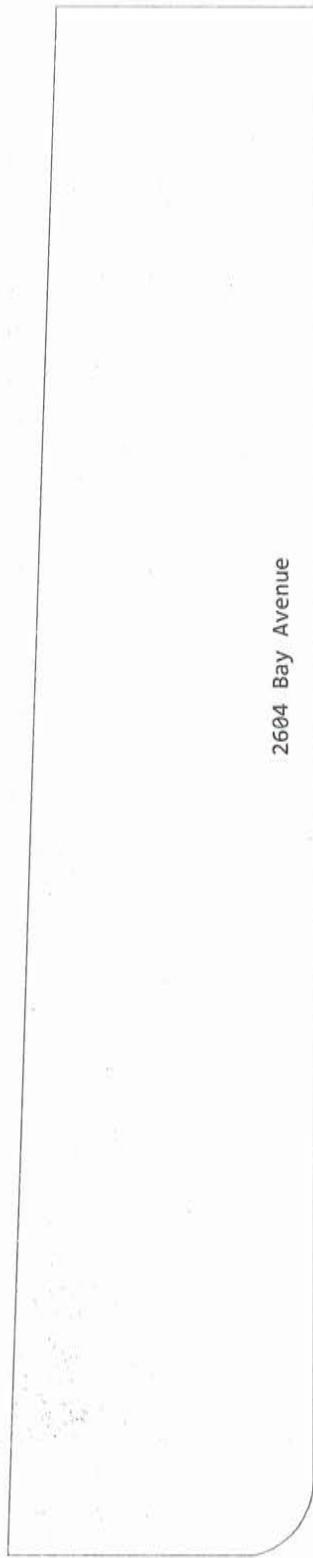

Z Street

2604 Bay Avenue

Edge of Pavement



Existing  
8" HDPE Water Main

Bay Avenue

Existing  
8" Gate Valve

26109 Z Street

26011 Z Street



North Beach Water District  
 Z Street Water Main Extension/Replacement Project  
 Shared Trench With Pacific PUD  
 July, 2014  
 Page 1 of 6

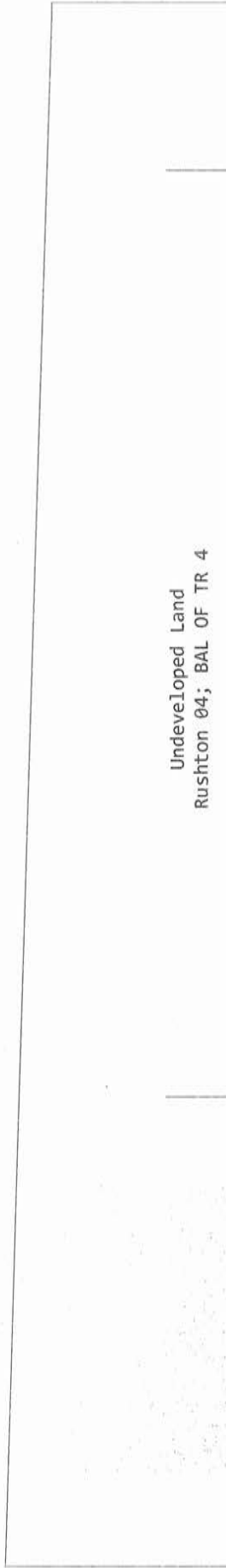

→ A

Z Street

← B

Edge of Pavement



25924 Z Street 25902 Z Street

Z Street

→ B

← C

Edge of Pavement

25921 Z Street

2680 259th Lane



Existing 4" Water Main  
259th Lane

25624 Z Street

Z Street

Edge of Pavement

25623 Z Street





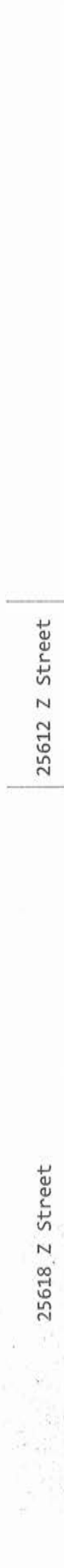

→ D

Z Street

← E

Edge of Pavement



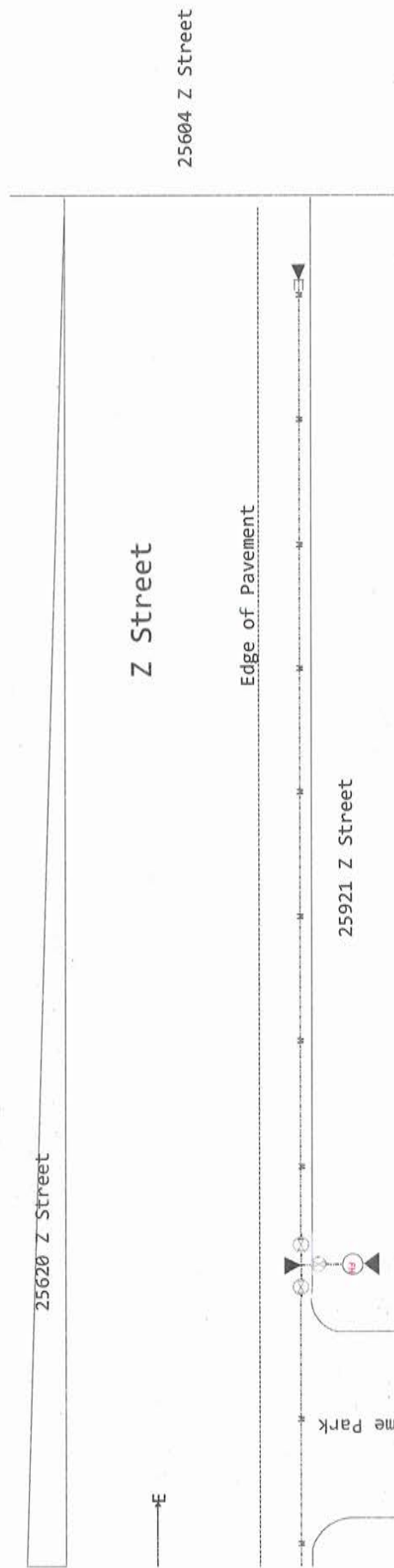

Scope of Work attached hereto and incorporated herein as Exhibit A.

**ADOPTED BY** the Board of Commissioners of North Beach Water District, Pacific County, Washington at its special meeting held on the 1<sup>st</sup> day of July, 2014.



---

Brian Sheldon, Commissioner  
Position #1

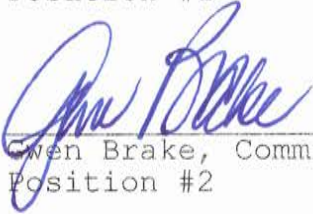

---

Owen Brake, Commissioner  
Position #2

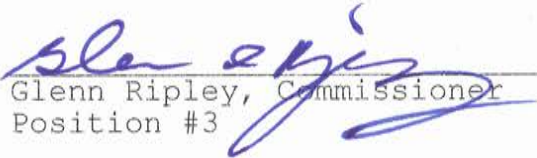

---

Glenn Ripley, Commissioner  
Position #3