

RIGHT-OF-WAY DISCLAIMER

The right-of-way and/or property lines shown hereon are based on available information, not on a surveyed location and are only approximate.

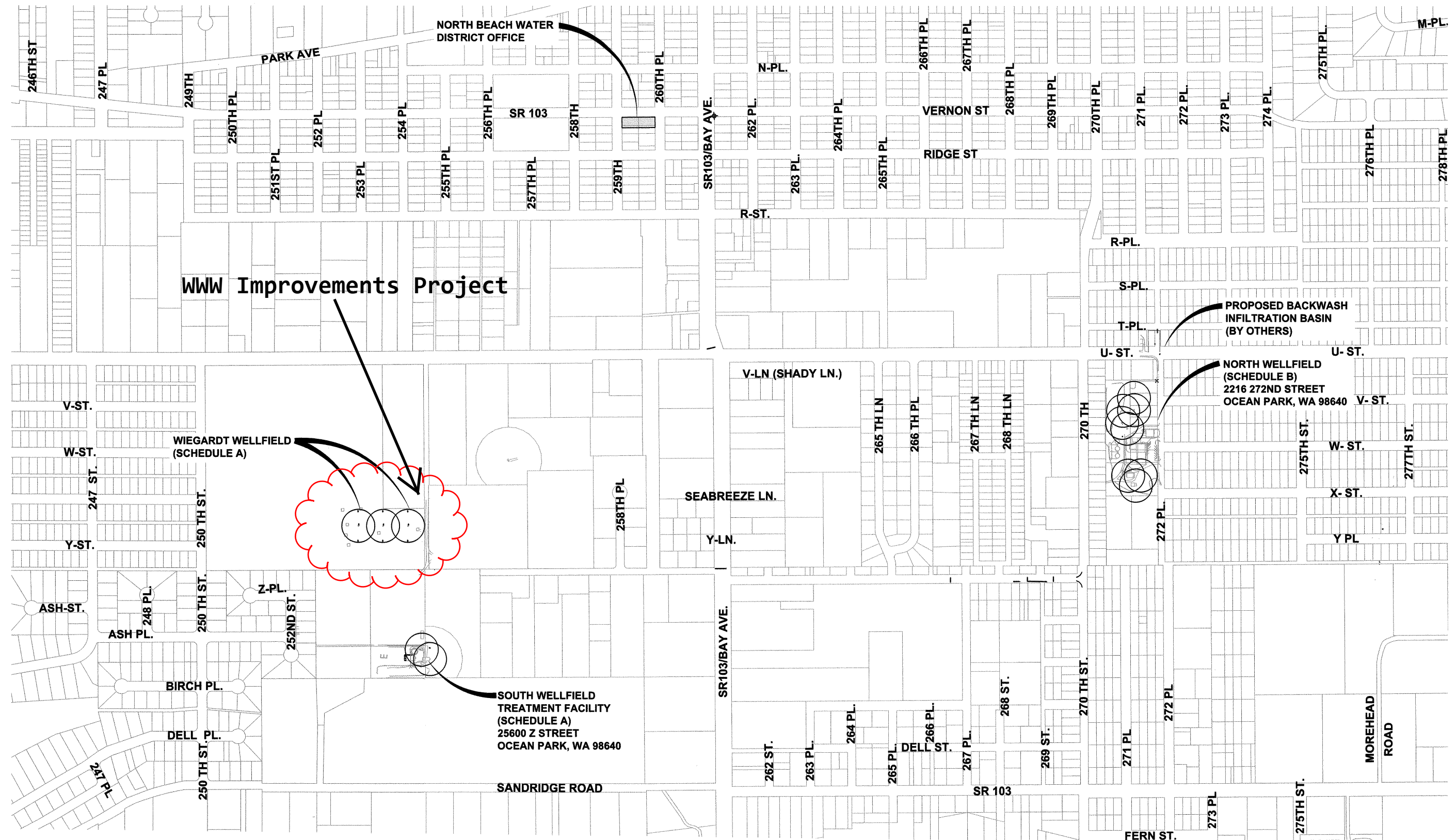
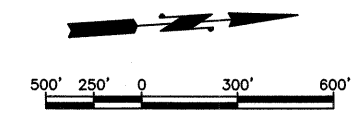

WW Improvements Project

PROPOSED BACKWASH INFILTRATION BASIN (BY OTHERS)

**NORTH WELLFIELD (SCHEDULE B)
2216 272ND STREET
OCEAN PARK, WA 98640**

WIEGARDT WELLFIELD (SCHEDULE A)

**SOUTH WELLFIELD TREATMENT FACILITY (SCHEDULE A)
25600 Z STREET
OCEAN PARK, WA 98640**

PROJECT LOCATION MAP
SCALE: 1"=300'

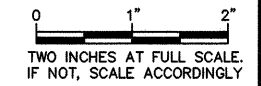

Gray & Osborne, Inc.
CONSULTING ENGINEERS
2102 CARRIAGE DRIVE SW, BLDG. 1
OLYMPIA, WA 98502 • (360) 292-7418

DATE:	FEB 2016
SCALE:	NOTED
DRAWN:	EMH
CHECKED:	SLG
APPROVED:	MBJ

No.	REVISION	DATE	APPD

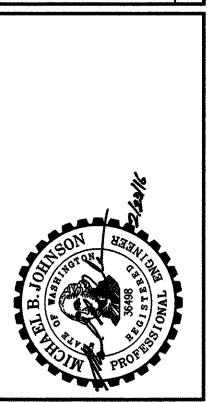

NORTH BEACH WATER DISTRICT
PACIFIC COUNTY WASHINGTON
WATER SUPPLY AND TREATMENT PROJECT REBID
PROJECT LOCATION MAP

SHEET:	G-2
OF:	7
JOB NO.:	13224.02
DWG:	VIC_LOC_MAP

RIGHT-OF-WAY DISCLAIMER

The right-of-way and/or property lines shown hereon are based on available information, not on a surveyed location and are only approximate.

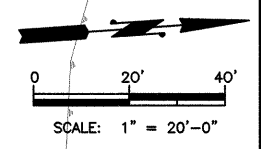

Existing Road = Approximately 5,800 square feet
Well #1 Pad = Approximately 1,600 square feet
Well #2 Pad = Approximately 900 square feet
Well #3 = Approximately 900 Square feet

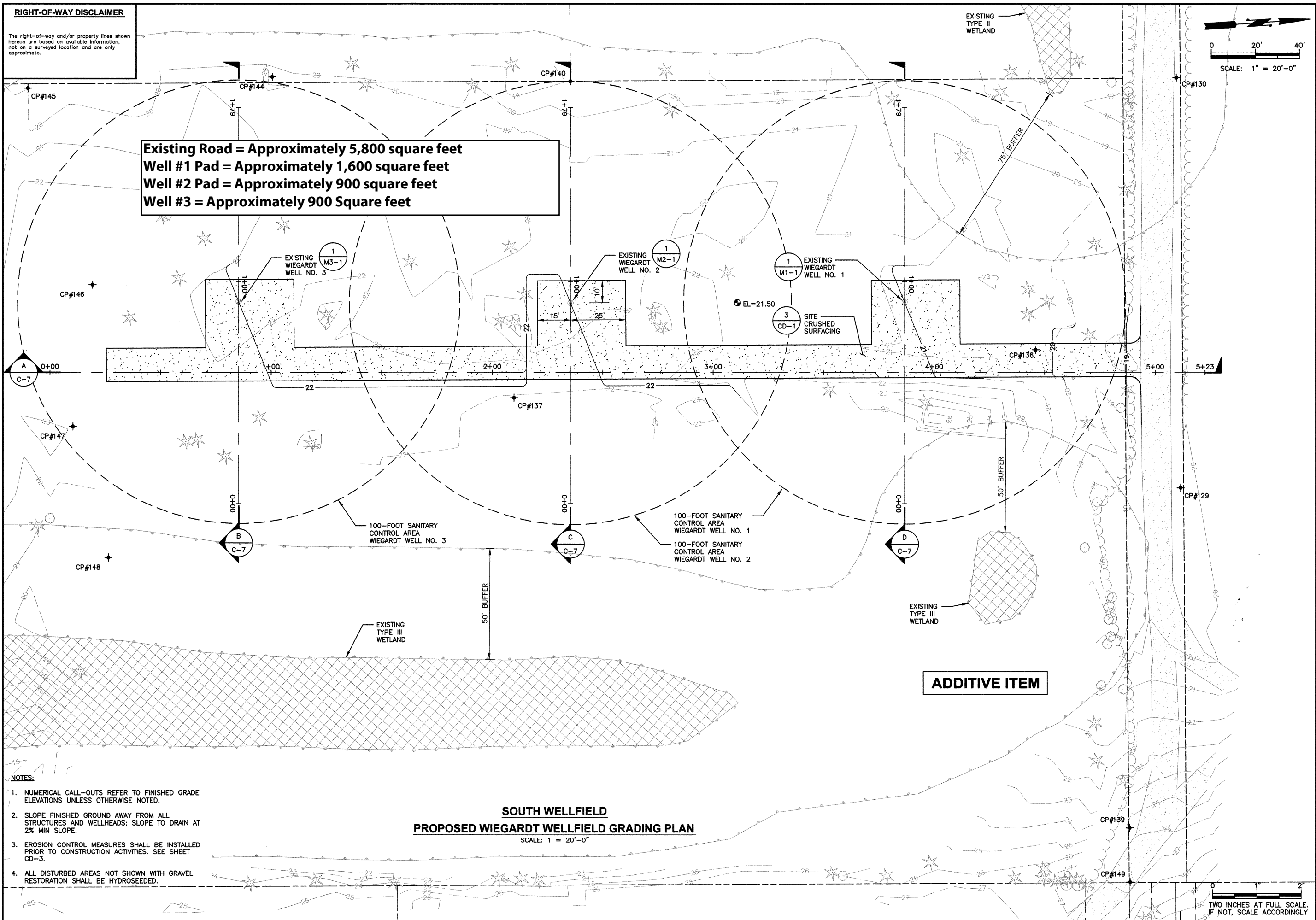

- NOTES:**
1. NUMERICAL CALL-OUTS REFER TO FINISHED GRADE ELEVATIONS UNLESS OTHERWISE NOTED.
 2. SLOPE FINISHED GROUND AWAY FROM ALL STRUCTURES AND WELLHEADS; SLOPE TO DRAIN AT 2% MIN SLOPE.
 3. EROSION CONTROL MEASURES SHALL BE INSTALLED PRIOR TO CONSTRUCTION ACTIVITIES. SEE SHEET CD-3.
 4. ALL DISTURBED AREAS NOT SHOWN WITH GRAVEL RESTORATION SHALL BE HYDROSEEDED.

SOUTH WELLFIELD
PROPOSED WIEGARDT WELLFIELD GRADING PLAN
 SCALE: 1" = 20'-0"

ADDITIVE ITEM

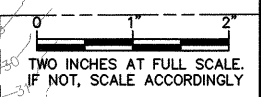

Gray & Osborne, Inc.
 CONSULTING ENGINEERS
 2102 CARRIAGE DRIVE SW, BLDG. 1
 OLMPIA, WA 98502 • (360) 292-7418

DATE: FEB 2016	SCALE: NOTED	DRAWN: EWH	CHECKED: SLG	APPROVED: MBJ
----------------	--------------	------------	--------------	---------------

No.	REVISION	DATE	APPD



NORTH BEACH WATER DISTRICT
 WASHINGTON
 WATER SUPPLY AND TREATMENT
 PROJECT REBID
 SOUTH WELLFIELD - PROPOSED
 WIEGARDT WELLFIELD - GRADING PLAN
 (ADDITIVE ITEM)

SHEET: **C-6**
 OF: **12**
 JOB NO.: 13224.02
 DWS: WELFLD PRO SITE PLN

EROSION/SEDIMENTATION CONTROL NOTES

1. ALL LIMITS OF CLEARING AND AREAS OF VEGETATION PRESERVATION SHALL BE OBSERVED DURING CONSTRUCTION.
2. ALL REQUIRED SEDIMENTATION/EROSION CONTROL FACILITIES MUST BE IN OPERATION PRIOR TO LAND CLEARING AND/OR OTHER CONSTRUCTION TO INSURE THAT SEDIMENT LADEN WATER DOES NOT ENTER THE NATURAL DRAINAGE SYSTEM. ALL EROSION AND SEDIMENT FACILITIES SHALL BE MAINTAINED IN A SATISFACTORY CONDITION UNTIL SUCH TIME THAT CLEARING AND /OR CONSTRUCTION IS COMPLETED AND THE POTENTIAL FOR ON-SITE EROSION HAS PASSED. THE IMPLEMENTATION, MAINTENANCE, REPLACEMENT AND ADDITIONS TO EROSION/SEDIMENTATION CONTROL SYSTEMS SHALL BE THE RESPONSIBILITY OF THE CONTRACTOR.
3. THE EROSION AND SEDIMENTATION CONTROL SYSTEMS DEPICTED ON THE DRAWINGS ARE IDENTIFIED IN SENSITIVE AREAS. NOT ALL EROSION CONTROL MEASURES ARE DEPICTED ON THE DRAWINGS. THE CONTRACTOR SHALL FOLLOW THE REQUIREMENTS OF THE BMPs THROUGHOUT THE ENTIRE WATER MAIN PROJECT. AS CONSTRUCTION PROGRESSES AND AS UNEXPECTED OR SEASONAL CONDITIONS DICTATE, THE CONTRACTOR SHOULD ANTICIPATE THAT MORE EROSION AND SEDIMENTATION CONTROL FACILITIES WILL BE NECESSARY TO INSURE COMPLETE SILTATION CONTROL ON THE PROPOSED SITE. DURING THE COURSE OF CONSTRUCTION, IT SHALL BE THE OBLIGATION AND RESPONSIBILITY OF THE CONTRACTOR TO ADDRESS ANY NEW CONDITIONS THAT MAY BE CREATED BY HIS ACTIVITIES AND TO PROVIDE ADDITIONAL FACILITIES, OVER AND ABOVE THE MINIMUM REQUIREMENTS, AS MAY BE NEEDED TO PROTECT ADJACENT PROPERTIES AND THE WATER QUALITY OF THE RECEIVING DRAINAGE SYSTEM.
4. AT NO TIME SHALL MORE THAN ONE FOOT OF SEDIMENT BE ALLOWED TO ACCUMULATE WITHIN A CATCH BASIN. THE CONTRACTOR SHALL BE RESPONSIBLE FOR REMOVING AND DISPOSING OF THE SEDIMENT. ALL CATCH BASINS, CONVEYANCE LINES AND DITCHES SHALL BE CLEANED PRIOR TO PAVING.
5. THE CONTRACTOR SHALL REMOVE MATERIAL DROPPED, WASHED OR TRACKED FROM VEHICLES ONTO THE COUNTY RIGHT-OF-WAY OR INTO THE EXISTING STORM DRAINAGE SYSTEM. DEBRIS SHALL NOT BE WASHED INTO THE STORM DRAINAGE SYSTEM.
6. TEMPORARY EROSION CONTROL FACILITIES SHALL BE INSPECTED WEEKLY AND MAINTAINED WITHIN 24 HOURS FOLLOWING A STORM EVENT. SEDIMENT SHALL BE REMOVED TO INSURE THE FACILITIES WILL FUNCTION PROPERLY. THE FACILITIES SHALL BE SATISFACTORILY MAINTAINED UNTIL CONSTRUCTION IS COMPLETED AND THE POTENTIAL FOR ON-SITE EROSION HAS PASSED.
7. ALL STORM DRAIN INLETS MADE OPERABLE DURING CONSTRUCTION SHALL BE PROTECTED SO THAT STORMWATER RUNOFF SHALL NOT ENTER THE CONVEYANCE SYSTEM WITHOUT FIRST BEING FILTERED OR OTHERWISE TREATED TO REMOVE SEDIMENT.
8. NO DISTURBED SOIL SHALL REMAIN UNSTABILIZED FOR MORE THAN TWO DAYS.

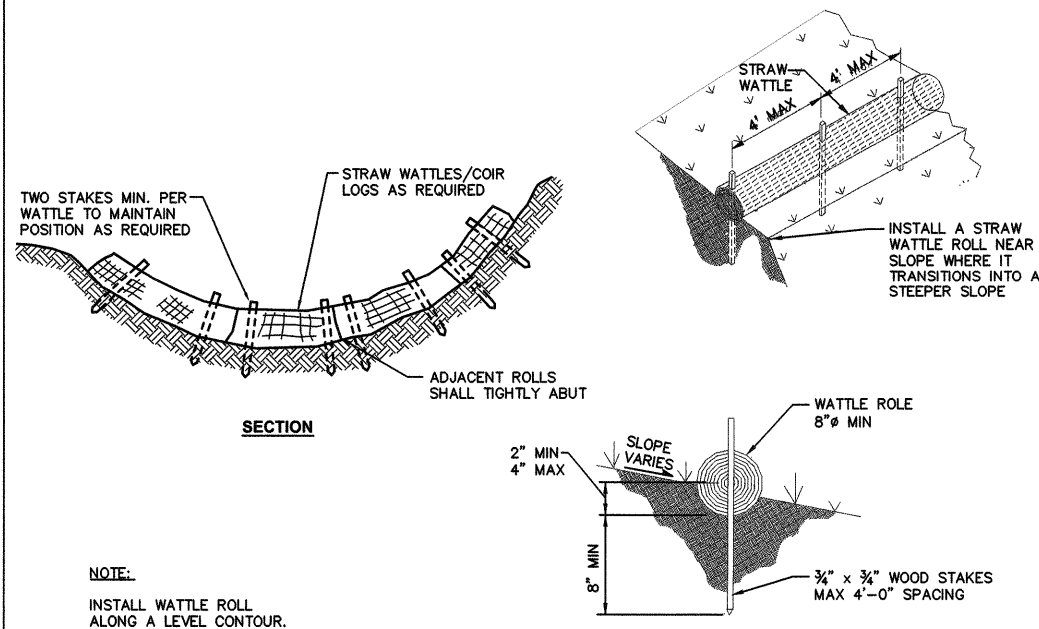

1 STRAW WATTLE ROLL DETAIL
TYP NOT TO SCALE

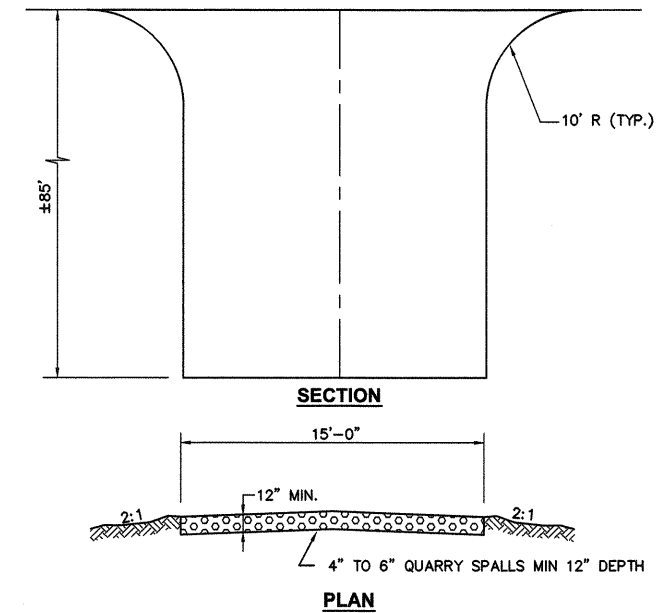

2 CONSTRUCTION ENTRANCE DETAIL
TYP NOT TO SCALE

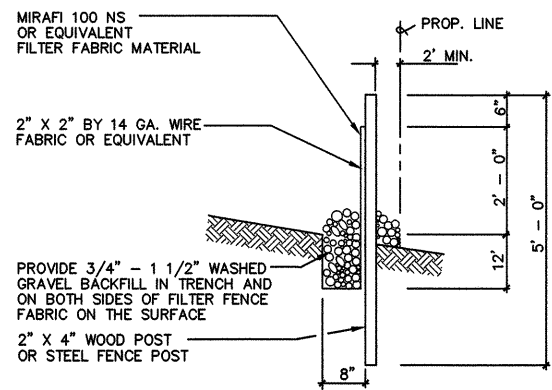

3 FILTER FABRIC FENCE SECTION
TYP NOT TO SCALE

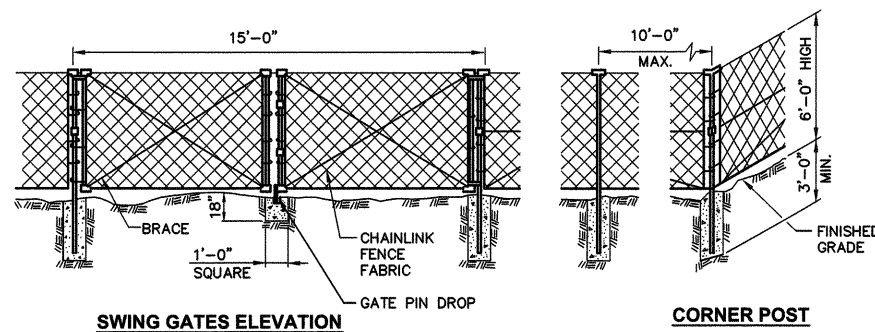

5 FENCE AND GATE DETAIL

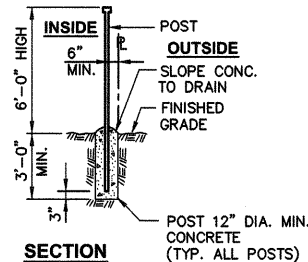

5 FENCE AND GATE DETAIL
TYP NOT TO SCALE

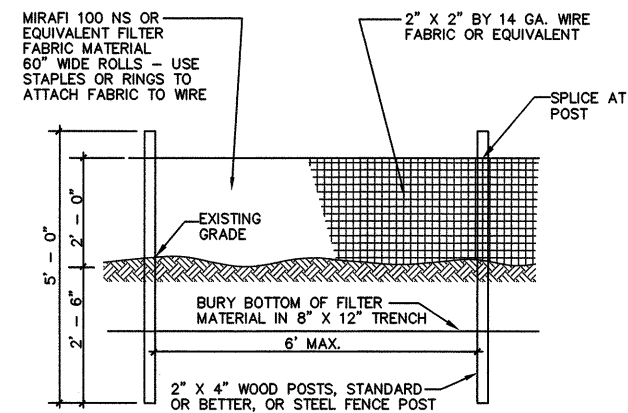

4 FILTER FABRIC FENCE ELEVATION
TYP NOT TO SCALE

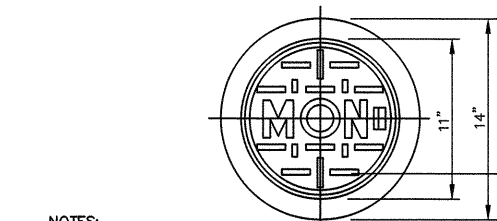

NOTES:

1. ALL EXISTING SURVEY MONUMENTS SHALL BE PRESERVED IN ACCORDANCE WITH WAC 332-120. SHOULD A MONUMENT NEED TO BE DISTURBED IN ORDER TO CONSTRUCT THE IMPROVEMENTS, THE CONTRACTOR SHALL PROMPTLY NOTIFY THE ENGINEER AND SHALL NOT DISTURB THE MONUMENT UNTIL THE CONTRACTOR HAS SUBMITTED AN APPLICATION TO THE DEPARTMENT OF NATURAL RESOURCES. ALL MONUMENTS SHALL BE REESTABLISHED PER THIS DETAIL.
2. CASTINGS FOR MONUMENT CASES, COVERS, AND RISERS SHALL BE GRAY IRON CASTINGS CONFORMING TO THE REQUIREMENTS OF AASHTO M 105, CLASS 30B.
3. THE COVER AND SEAT SHALL BE MACHINED SO AS TO HAVE PERFECT CONTACT AROUND THE ENTIRE CIRCUMFERENCE AND FULL WIDTH OF BEARING SURFACE.

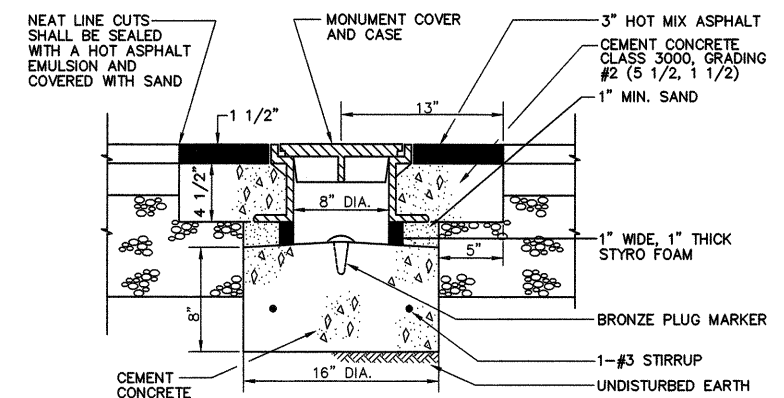

6 SURVEY MONUMENT DETAIL
TYP NOT TO SCALE

0 1" 2"
TWO INCHES AT FULL SCALE.
IF NOT, SCALE ACCORDINGLY

DATE: FEB 2016	NOTED	EWJ	SLG	MBJ
SCALE:	DRAWN:	CHECKED:	APPROVED:	

	APPD
	DATE
	REVISION
	No.

