

**RIGHT-OF-WAY DISCLAIMER**

The right-of-way and/or property lines shown hereon are based on available information, not on a surveyed location and are only approximate.

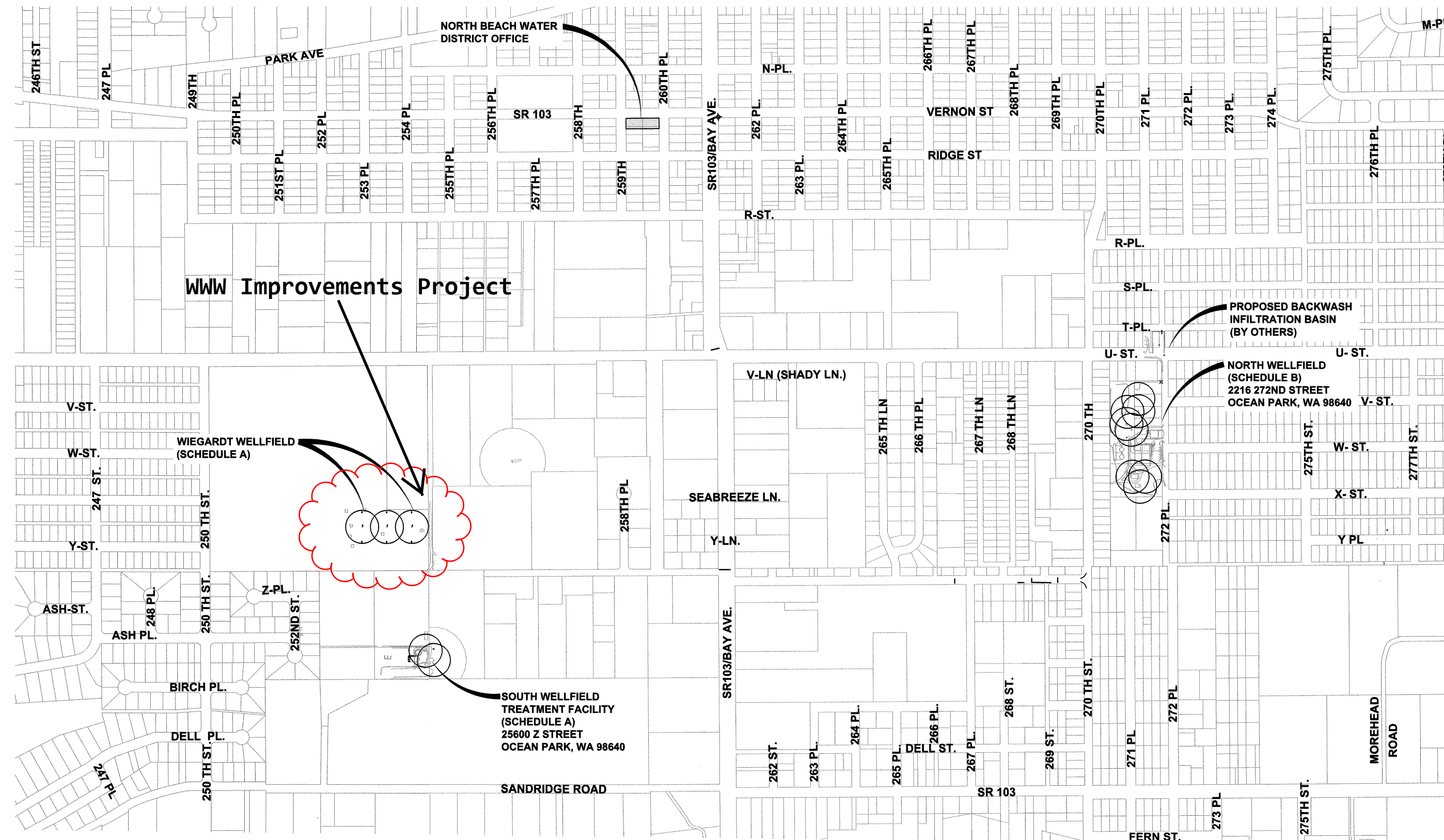

**PROJECT LOCATION MAP**  
SCALE: 1"=300'

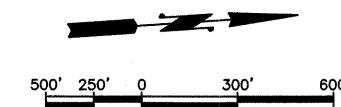
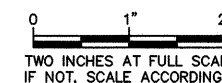

DATE: FEB 2016	SCALE: NOTED	DRAWN: EWH	CHECKED: SLG	APPROVED: MBJ
----------------	--------------	------------	--------------	---------------

No.	REVISION	DATE	APPD

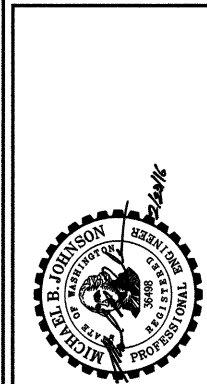

**NORTH BEACH WATER DISTRICT**  
PACIFIC COUNTY WASHINGTON  
**WATER SUPPLY AND TREATMENT**  
**PROJECT REBID**  
**PROJECT LOCATION MAP**

SHEET: <b>G-2</b>
OF: <b>7</b>
JOB NO.: 13224.02
DWG: VIC_LOC_MAP

The right-of-way and/or property lines shown hereon are based on available information, not on a surveyed location and are only approximate.

The right-of-way and/or property lines shown hereon are based on available information, not on a surveyed location and are only approximate.

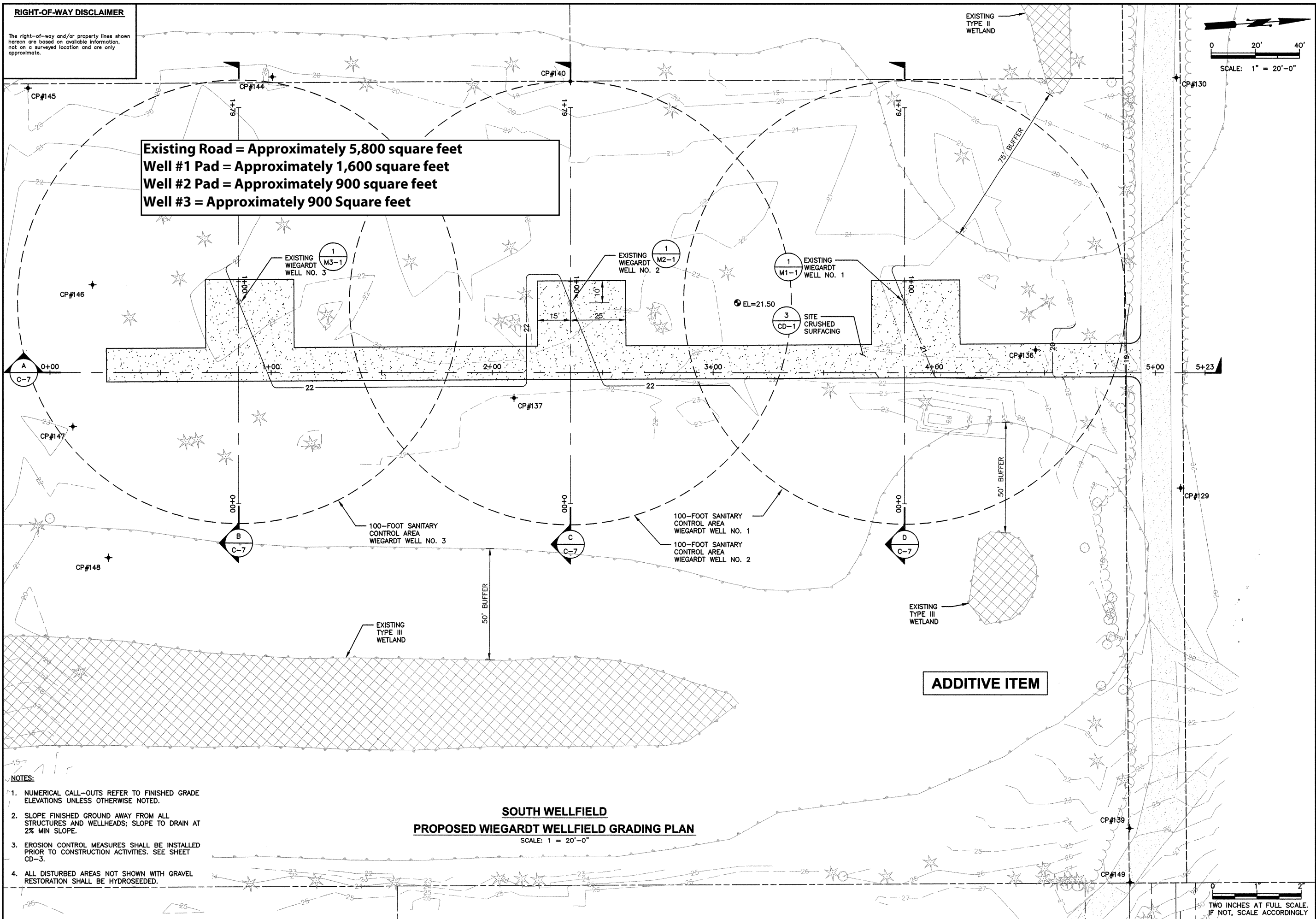

**Gray & Osborne, Inc.**  
CONSULTING ENGINEERS  
2102 CARRIAGE DRIVE SW, BLDG. J  
OLYMPIA, WA 98502 • (360) 292-7418

DATE: FEB 2016	
SCALE: NOTED	
DRAWN: EWH	
CHECKED: SLG	
APPROVED: MBJ	

No.	REVISION	DATE	APPD



**WATER SUPPLY AND TREATMENT  
PROJECT REBID  
SOUTH WELLFIELD -PROPOSED  
WIEGARDT WELLFIELD - GRADING PLAN  
(ADDITIVE ITEM)**

SHEET: **C-6**  
OF: **12**

JOB NO.: 13224.02  
DWS: WELFLD PRO STE PLN

EROSION/SEDIMENTATION CONTROL NOTES

1. ALL LIMITS OF CLEARING AND AREAS OF VEGETATION PRESERVATION SHALL BE OBSERVED DURING CONSTRUCTION.
2. ALL REQUIRED SEDIMENTATION/EROSION CONTROL FACILITIES MUST BE IN OPERATION PRIOR TO LAND CLEARING AND/OR OTHER CONSTRUCTION TO INSURE THAT SEDIMENT LADEN WATER DOES NOT ENTER THE NATURAL DRAINAGE SYSTEM. ALL EROSION AND SEDIMENT FACILITIES SHALL BE MAINTAINED IN A SATISFACTORY CONDITION UNTIL SUCH TIME THAT CLEARING AND /OR CONSTRUCTION IS COMPLETED AND THE POTENTIAL FOR ON-SITE EROSION HAS PASSED. THE IMPLEMENTATION, MAINTENANCE, REPLACEMENT AND ADDITIONS TO EROSION/SEDIMENTATION CONTROL SYSTEMS SHALL BE THE RESPONSIBILITY OF THE CONTRACTOR.
3. THE EROSION AND SEDIMENTATION CONTROL SYSTEMS DEPICTED ON THE DRAWINGS ARE IDENTIFIED IN SENSITIVE AREAS. NOT ALL EROSION CONTROL MEASURE ARE DEPICTED ON THE DRAWINGS. THE CONTRACTOR SHALL FOLLOW THE REQUIREMENTS OF THE BMPs THROUGHOUT THE ENTIRE WATER MAIN PROJECT. AS CONSTRUCTION PROGRESSES AND AS UNEXPECTED OR SEASONAL CONDITIONS DICTATE, THE CONTRACTOR SHOULD ANTICIPATE THAT MORE EROSION AND SEDIMENTATION CONTROL FACILITIES WILL BE NECESSARY TO INSURE COMPLETE SILTATION CONTROL ON THE PROPOSED SITE. DURING THE COURSE OF CONSTRUCTION, IT SHALL BE THE OBLIGATION AND RESPONSIBILITY OF THE CONTRACTOR TO ADDRESS ANY NEW CONDITIONS THAT MAY BE CREATED BY HIS ACTIVITIES AND TO PROVIDE ADDITIONAL FACILITIES, OVER AND ABOVE THE MINIMUM REQUIREMENTS, AS MAY BE NEEDED TO PROTECT ADJACENT PROPERTIES AND THE WATER QUALITY OF THE RECEIVING DRAINAGE SYSTEM.
4. AT NO TIME SHALL MORE THAN ONE FOOT OF SEDIMENT BE ALLOWED TO ACCUMULATE WITHIN A CATCH BASIN. THE CONTRACTOR SHALL BE RESPONSIBLE FOR REMOVING AND DISPOSING OF THE SEDIMENT. ALL CATCH BASINS, CONVEYANCE LINES AND DITCHES SHALL BE CLEANED PRIOR TO PAVING.
5. THE CONTRACTOR SHALL REMOVE MATERIAL DROPPED, WASHED OR TRACKED FROM VEHICLES ONTO THE COUNTY RIGHT-OF-WAY OR INTO THE EXISTING STORM DRAINAGE SYSTEM. DEBRIS SHALL NOT BE WASHED INTO THE STORM DRAINAGE SYSTEM.
6. TEMPORARY EROSION CONTROL FACILITIES SHALL BE INSPECTED WEEKLY AND MAINTAINED WITHIN 24 HOURS FOLLOWING A STORM EVENT. SEDIMENT SHALL BE REMOVED TO INSURE THE FACILITIES WILL FUNCTION PROPERLY. THE FACILITIES SHALL BE SATISFACTORY MAINTAINED UNTIL CONSTRUCTION IS COMPLETED AND THE POTENTIAL FOR ON-SITE EROSION HAS PASSED.
7. ALL STORM DRAIN INLETS MADE OPERABLE DURING CONSTRUCTION SHALL BE PROTECTED SO THAT STORMWATER RUNOFF SHALL NOT ENTER THE CONVEYANCE SYSTEM WITHOUT FIRST BEING FILTERED OR OTHERWISE TREATED TO REMOVE SEDIMENT.
8. NO DISTURBED SOIL SHALL REMAIN UNSTABILIZED FOR MORE THAN TWO DAYS.

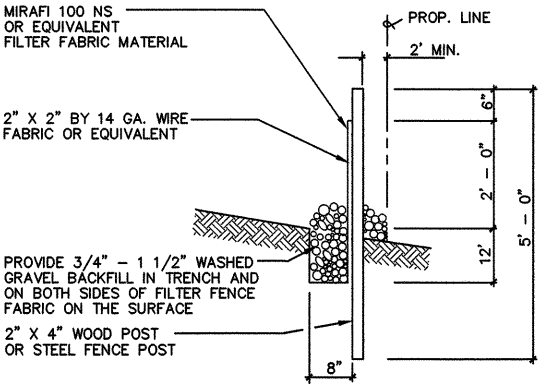

3  
TYP  
NOT TO SCALE

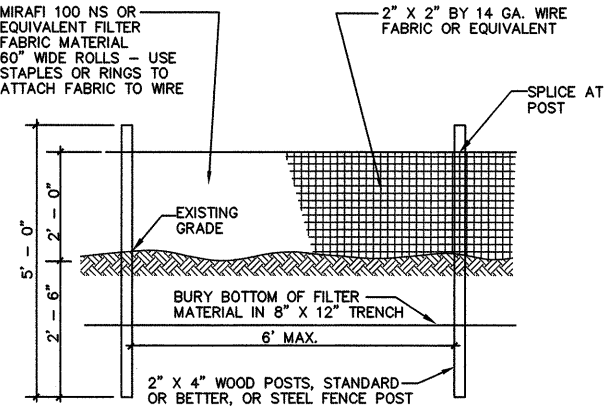

4  
TYP  
NOT TO SCALE

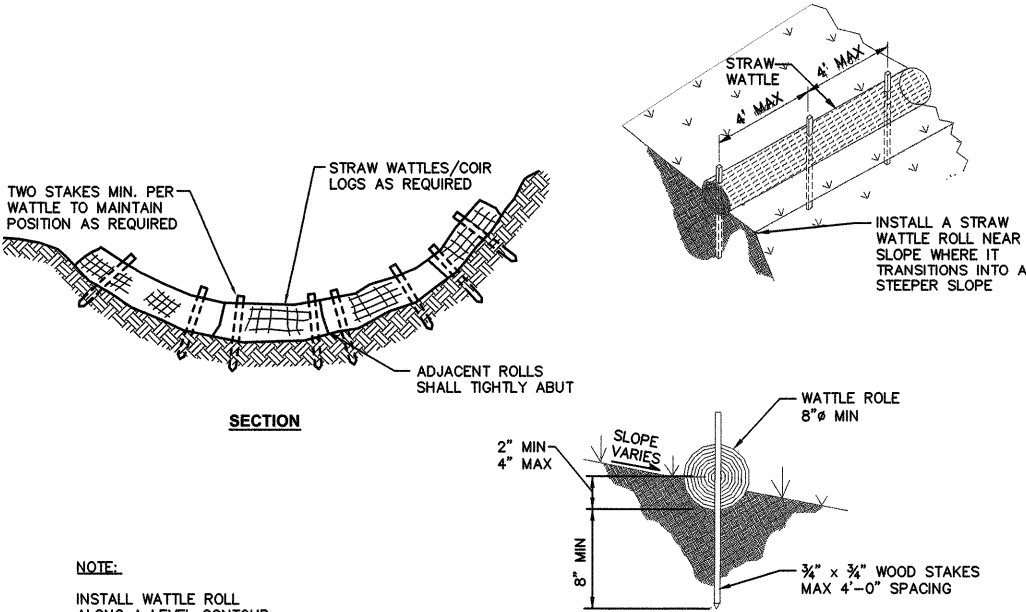

1  
TYP  
NOT TO SCALE

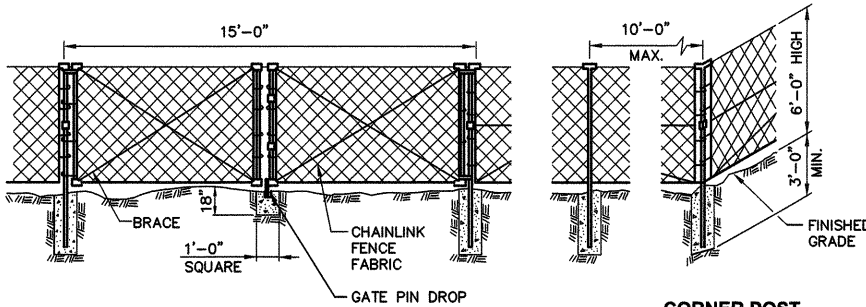

FENCE AND GATE DETAIL

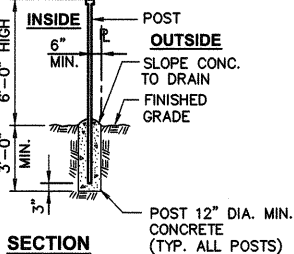

5  
TYP  
NOT TO SCALE

- NOTES:
1. CHAINLINK FENCE & DOUBLE SWING GATES SHALL BE FURNISHED & INSTALLED ACCORDING TO THE WASHINGTON STATE DEPARTMENT OF TRANSPORTATION STANDARD PLAN L-20.10.
2. CORNER POSTS SHALL BE INSTALLED AT ALL POINTS WHERE THE ALIGNMENT CHANGES 30° OR MORE.
3. CONTRACTOR SHALL PROVIDE KNOX PADLOCK PER THE SPECIFICATIONS.
4. GATE SHALL HAVE A MINIMUM OF 6-INCH OF CLEARANCE BETWEEN BOTTOM GRADE AND THE TRAVELED SURFACE, THROUGH ITS ENTIRE OPERATING ARC.

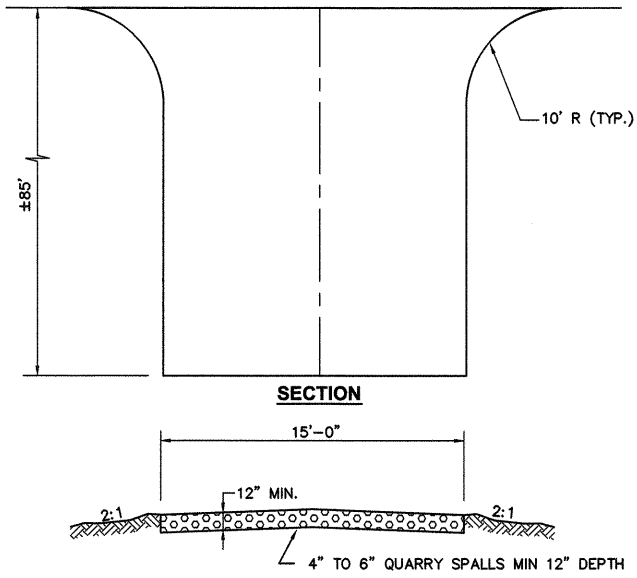

2  
TYP  
NOT TO SCALE

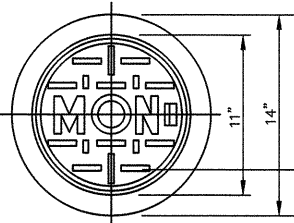

- NOTES:
1. ALL EXISTING SURVEY MONUMENTS SHALL BE PRESERVED IN ACCORDANCE WITH WAC 332-120. SHOULD A MONUMENT NEED TO BE DISTURBED IN ORDER TO CONSTRUCT THE IMPROVEMENTS, THE CONTRACTOR SHALL PROMPTLY NOTIFY THE ENGINEER AND SHALL NOT DISTURB THE MONUMENT UNTIL THE CONTRACTOR HAS SUBMITTED AN APPLICATION TO THE DEPARTMENT OF NATURAL RESOURCES. ALL MONUMENTS SHALL BE REESTABLISHED PER THIS DETAIL.
2. CASTINGS FOR MONUMENT CASES, COVERS, AND RISERS SHALL BE GRAY IRON CASTINGS CONFORMING TO THE REQUIREMENTS OF AASHTO M 105, CLASS 30B.
3. THE COVER AND SEAT SHALL BE MACHINED SO AS TO HAVE PERFECT CONTACT AROUND THE ENTIRE CIRCUMFERENCE AND FULL WIDTH OF BEARING SURFACE.

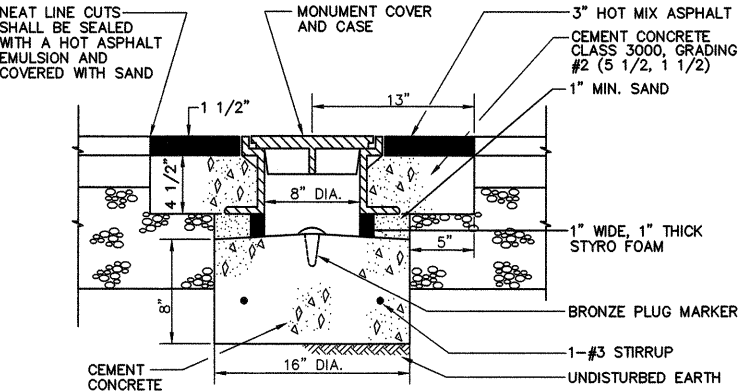

6  
TYP  
NOT TO SCALE



**Gray & Osborne, Inc.**  
CONSULTING ENGINEERS  
2102 CARRIAGE DRIVE SW, BLDG. 1  
OLYMPIA, WA 98502 • (360) 292-7418

DATE: FEB 2016	SCALE:	NOTED	EWB	SLG	MBJ
DRAWN:	CHECKED:	APPROVED:			

	APPD
	DATE
	REVISION
No.	



**NORTH BEACH WATER DISTRICT**  
PACIFIC COUNTY WASHINGTON  
**WATER SUPPLY AND TREATMENT PROJECT REBID**  
EROSION CONTROL DETAILS